

ISSUE:

Issued for Permit
08.05.2016



BASE⁴

BASE4
9858 GLADES ROAD, #237
BOCA RATON, FLORIDA 33434
1.720.72BASE4 www.base-4.com

JEFF GAITHER, AIA
4101 Woodlynne Ln
Orlando, FL 32812

Seal:

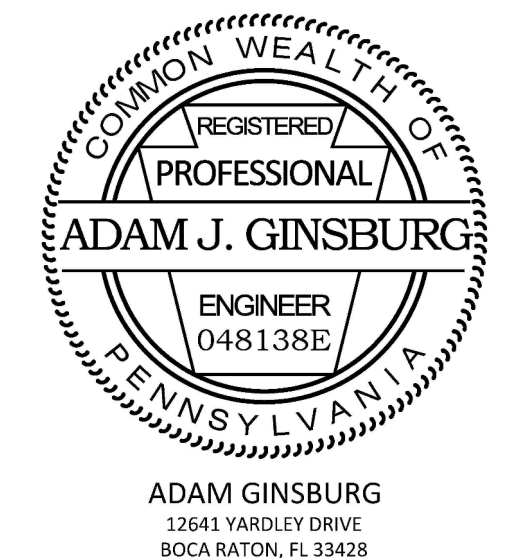

PROJECT: B4-067-1603

Hampton Inn & Suites

New Stanton, PA 15672

OWNER:

Stanton Hospitality LLC

52 Blueberry Lane,
Grove City, PA 16127

THESE DRAWINGS ARE FOR REVIEW OF DESIGN AND SCOPE DESCRIPTION ONLY. NO REPRESENTATION IS MADE TO THE ACCURACY OF THE DRAWINGS WITH RESPECT TO EXISTING DIMENSIONS OR CONDITIONS. ALL CONSULTANTS AND CONTRACTORS MUST VERIFY ANY AND ALL DIMENSIONS AND CONDITIONS WHICH ARE CRITICAL TO THEIR WORK. THESE DRAWINGS ARE INSTRUMENTS OF SERVICE AND ARE THE INTELLECTUAL PROPERTY OF JMAC ARCHITECTS. ANY UNAUTHORIZED USE OR REPRODUCTION IS PROHIBITED.

[illegible]

1ST FLOOR WALL AND COLUMN PLAN

$$3/32" = 1'-0"$$

S-201.2

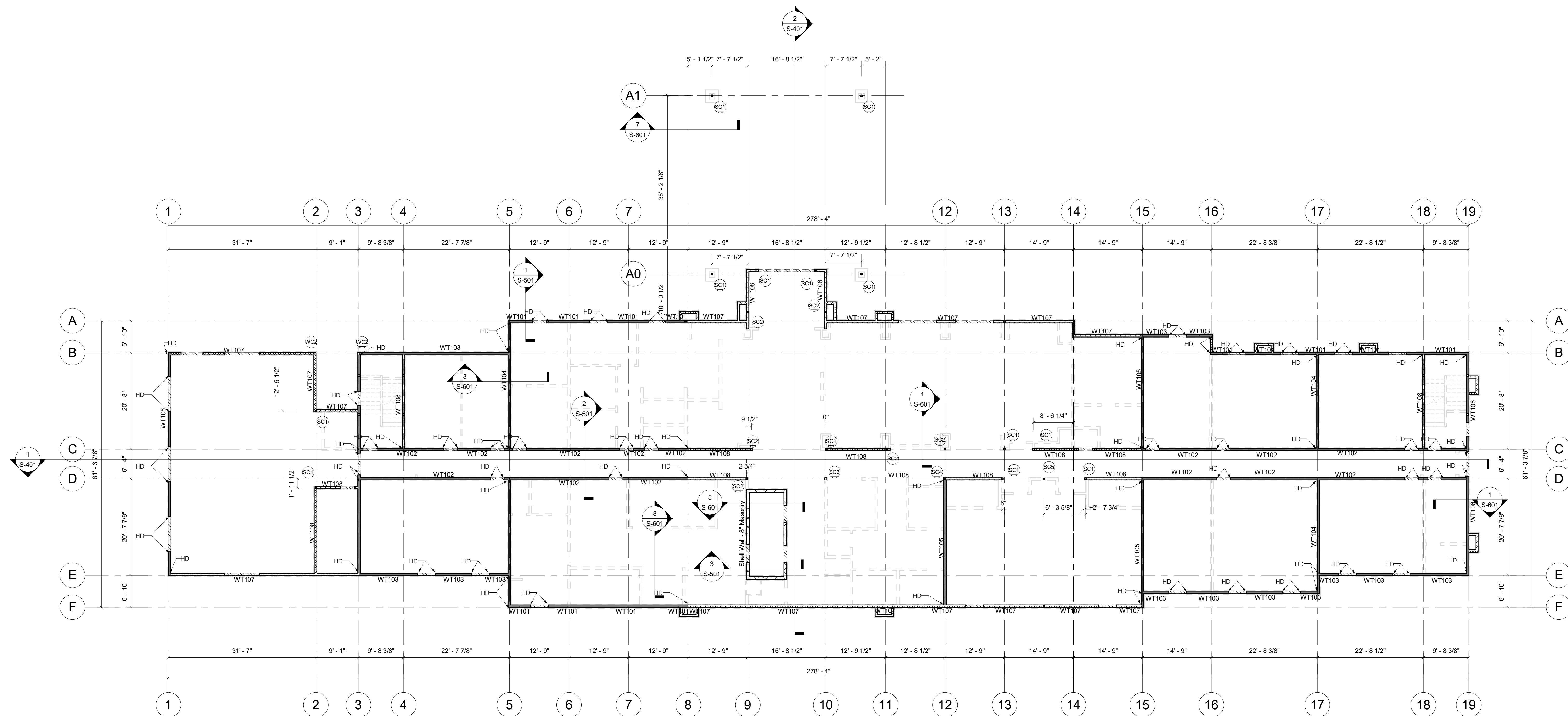

1ST FLOOR WALL AND COLUMN PLAN

SCALE: $3/32" = 1'-0"$

NOTES:

NOTES:
1. REFER TO ARCH & MEP FOR OPENING DIMENSIONS ON THIS FLOOR.
2. SHEAR/BEARING WALLS ON THIS PLAN ELEVATED FROM $+0 \rightarrow +12'-4"$ U.N.O.
COLUMN ON THIS PLAN ELEVATED FROM TOP OF FOOTING—BOTTOM OF STEEL BEAM
EXCEPT MARKED
3. 'HD' DENOTES HOLDDOWN. SEE WALL TYPE SCHEDULE FOR HOLDDOWN TYPE ON S-103.
4. ALL SHEATHING SCHEDULED IS MINIMUM. CONTRACTOR TO INCREASE AS REQUIRED
TO ALIGN GYPSOBOARD AND SHEATHING FOR PROPER TRANSITIONS.